

Specification Sheet of Super Capacitor

P.N.: MZ2R7222B Value: 2.7V/2200F

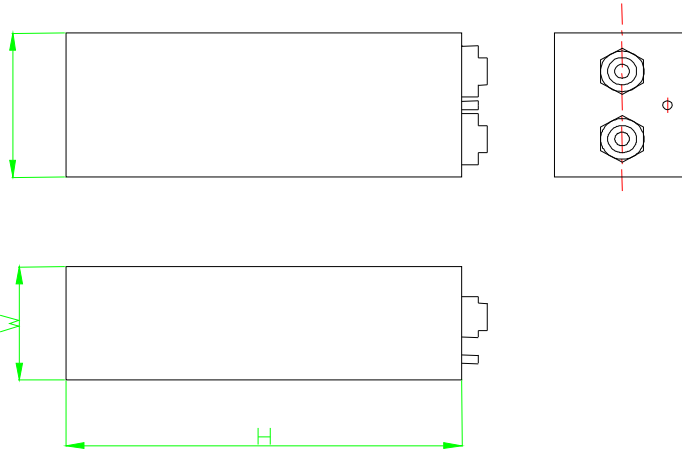

SPECIFICATION:

Part No.	MZ2R7222B
Capacitance	2200 F
Resistance (ESR _{DC})	≤2mΩ
Capacitance Tolerance	-10%~20%
Rated Voltage	2.7V
Surge Voltage	3.0V
Leakage Current	≤6mA; rated voltage 24h
Operating Temperature	-40°C~+70°C
Temperature Characteristics	+70°C ΔC/C ≤30%, ESR≤initial measured value -40°C ΔC/C ≤50%, ESR≤3 times initial measured value
Load Life	1000h, +70°C ±2, rated voltage, ΔC/C ≤30%, ESR≤4 times initial measured value
Self-Life	1000h, +70°C ±2, ΔC/C ≤30%, ESR≤4 times initial measured value
Moisture Life	+40°C ±2, 90~95%RH, 240h, ΔC/C ≤30%, I _L ≤2 times initial measured value, ESR≤4 times initial measured value
Weight	g
Dimension (T×W×H)	70(±2)×80(±2)×90(±2)mm
Circulation Life	Voltage 2.7V~1.35V, temp.+25°C, Circulation charging and discharging 500, 000 times, ΔC/C ≤30%, ESR≤3 times initial measured value

Note: Special Dimension are available on request.